

Model type:  
**P604(IX)**

Commercial code:  
**F023854**

## General notes

### Technical Documentation guidelines

---

---

You can find herewith some generic information to simplify consulting of technical documentation:

1. Models of same range share the same exploded views, which report the richest set of spare parts: generally, a model does not necessarily have a related spare part for each particular shown on exploded views.
2. Some spare parts can not be represented directly on the exploded views (instruction booklets, specific kit, etc...). You can find those codes in the spare parts list with the same reference of particular where spares are installed or with references 099, 999. Instruction booklets, once managed, appear with 000 reference.
3. On the higher right site of each exploded view there is a serial number which indicates the beginning of the production of certain range: some models might have more than an exploded view for a given category, each distinguished by a different serial no. and linked to another spare parts list, In this case, serial no. is required to supply the right spare part code. Exploded view to be considered is the one with a more recent serial no. but previous than the one of the model that needs assistance.
4. Exploded views might require further updates even after publishing. Addition of new spares will go on following the already existing numeration references. Revision number of an exploded view is shown into last four digits of serial number into upper right hand corner.
5. The spare parts list associated to an exploded view shows related codes of spares managed for a certain model; for each spare part other informations are available:  
  
REF: reference no of spare into a table; SUBSTITUTE: list of spare(s) which can replace a code but that keeps same functional characteristics  
  
INDUSTRIAL CODE: list of variables of a model (shown into model label) where such spare is used; NOTICE: code of information(s) to refer to complete technical intervention, track for changes or to find correct spare part code.
6. Some notices, into a same section are generic therefore cannot be directly linked to a spare part. In order to assist a model in the best way as possible, it is helpful to pay attention to all notices and constantly verify documentation updates
7. Technical documentation cover shows model name and its commercial codes

4140220

Exploded views

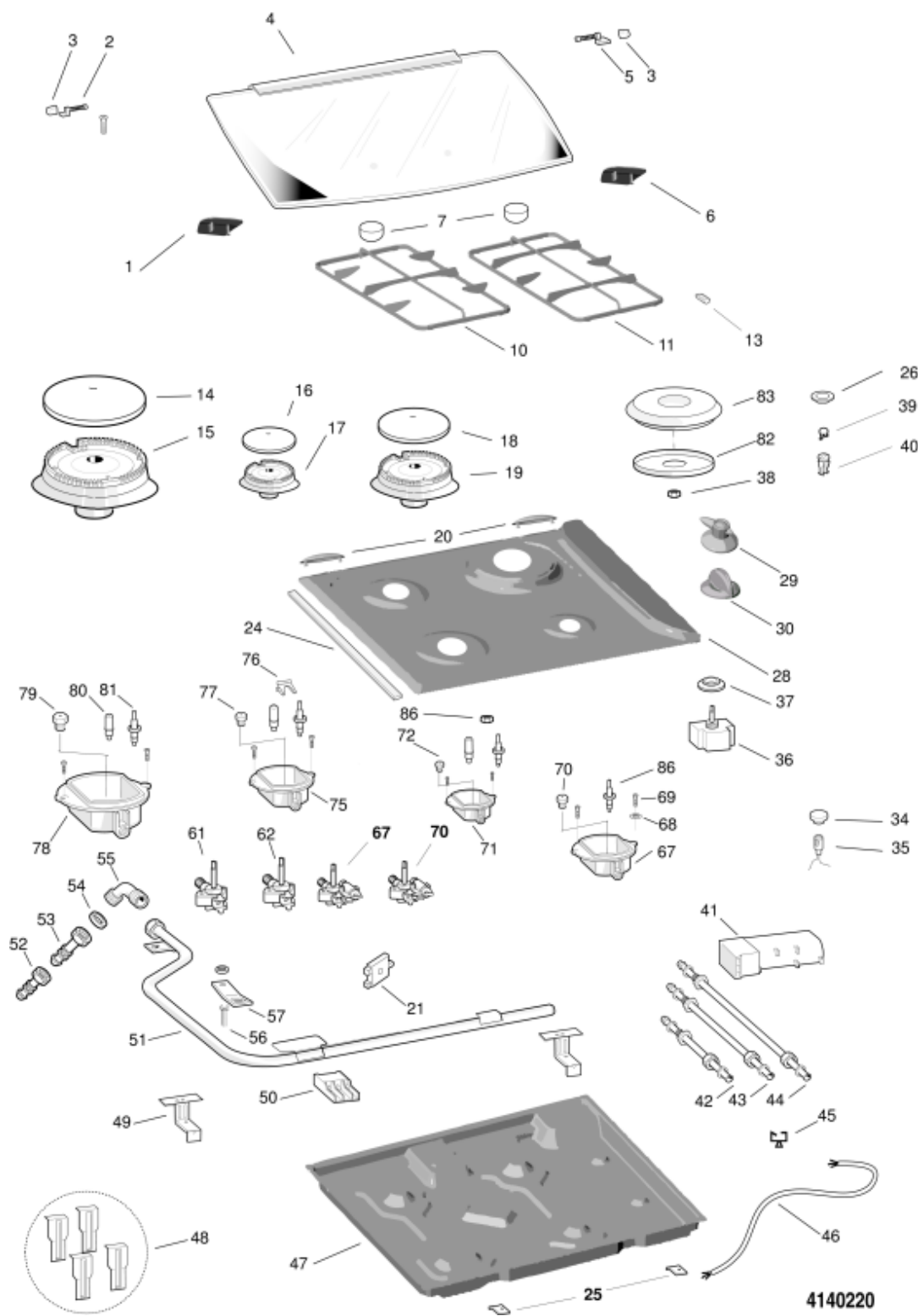

4140220

4140220

Spare parts list

Ref.	Code	From	To S/N	Substitute	Description	Notice	Industrial
000	C00048410				user instruction book for built-in		
001	C00075072				lid hinge blanking plug left hand		
006	C00075071				lid hinge hole blanking plug right		
024	C00018723			1 x C00018819	sealing gasket - hob/worktop		
028	C00075091				hob top stainless steel inox		
030	C00075064				control knob 6mm black		
034	C00036428				pilot light lens - yellow		
035	C00028054				pilot light - horizontal fitting red		
036	C00075092				electric commutator for plate 4		
037	C00028917				insert fix under knob disc to		
038	C00009296			1 x C00002506	nut m6x6x10		
045	C00280173				junction clamp richco		
047	C00075093				base cover p04		
048	C00052952				clamp kit - hob/worktop		
049	C00052968				tap bracket		
050	C00052959				terminal block trifase itw p.i.		
082	C00009306				element cover - 145mm plate		
082	C00031687				element cover - 180mm		
083	C00030938				electric plate d=180 220v 2kv_sb		
083	C00030939				electric plate d=145 220v		
099	C00013398			1 x C00029158	element support		
099	C00052918			1 x C00143845	support bracket - glass cover		

Electric schemes and links

Cod. se045300

SE045300

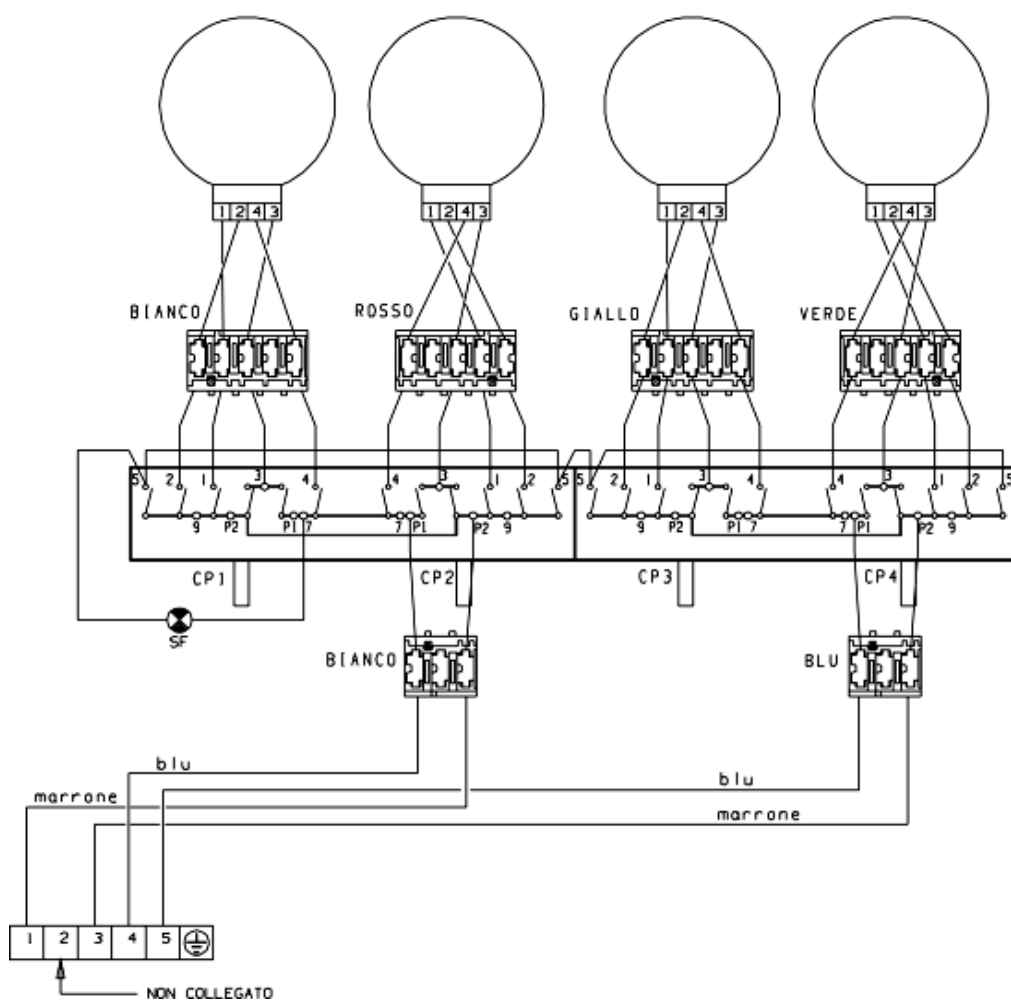

## Legend

Legend: se045300

AE	Ignition transformer	PE	Plate electric (Normal and Rapid)
AT	Ignition transformer	PEL	Wall socket
CF	Oven commutator	PIF	Cooking programmer
CP	Plate commutator(Normal end Rapid)	POT	Thermostated potentiometer
CT	Plate commutator(Automatic)	PT	Termoprotector
DC DR	Double Knob double crown burner control card	PTC	Thermostated sensor
EV	Electro-Valve	RCE	Grill heating element ex- ternal
FC	End of cooking programmer	RCI	Grill heating element internal
FRONT	Daschboard	RE	Energy regulator
I/LF	OVEN LIGHT SWITCH	RF	Oven lower heating element
I/LF-MG	OVEN LIGHT SWITCH + ROTISSERIE	RG	Grill heating element
I/MG	TURNSPIT SWITCH	RG COM	Grill heating element un- ion
IL	Knobs' Lighting	RV	Heating element ventilated oven
ILG	Lamp switch turnspit	SA	Boiler operating led
IT	Thermostated switch	SB	Thermostated burner led
L	Line (Feed)	SF	Warning light working
LF	Oven light	SO	Probe temperature
LI	Oven light	SP	Operating Indicator Light for the Plate
M	Suction motor handle	ST	Warning light thermostat
MG	Turnspit motor	TH	Thermostat fixed
MO	Terminal board	TH2	Thermostated burner cooling
MUFF	Oven	THR	Adjustable thermostat
MV	Fan motor	TP	Termoprotector
N	Neutral (Feed)	TRAV	Support terminal board
PA	Ignition push-button	TRM	Thermostated burner control card